

DF



Other available versions
(M08-M12)

DF-220M08 DF-220M12
DF-330M08 DF-330M12
DF-440M08 DF-440M12
DF-770M08 DF-770M12

Cable extensions

DHF-033 M08 = 3 m M08
DHF-033 M12 = 3 m M12
DHF-053 M08 = 5 m M08
DHF-053 M12 = 5 m M12

Type	ELECTROMECHANICAL			ELECTRONIC
	DF-220	DF-330	DF-440	PNP
Part No.	DF-220	DF-330	DF-440	DF-770
Working voltage (V AC/DC)	5÷30 V AC/DC	5÷30 V AC/DC	5÷30 V AC/DC	5÷30 V DC
Max switching voltage (mA)	100	100	100	100
Max switching power (W/VA)	3	3	3	3
Max voltage drop (V AC/DC)	<3,5	0,1	0,1	0,7
Minimum magnetic field (gauss)	60	60	60	30
Opening response time (ms)	< 0,5	< 0,5	< 0,5	0,08
Closing response time (ms)	< 1	< 1	< 1	0,03
Electric life with resistive load (cycles)	>10 ⁷	>10 ⁷	>10 ⁷	>10 ⁹
State indicator (LED)	red	red	red	red
Cable number and section (mmq)	2x0,14	3x0,14	3x0,14	3x0,14
Cable length (mm)	3000	3000	3000	3000
Electric circuit	A	C	D	C
Protection degree (EN60529)	IP67			
Working temperature (°C)	-20 ÷ +80			

Fixing elements

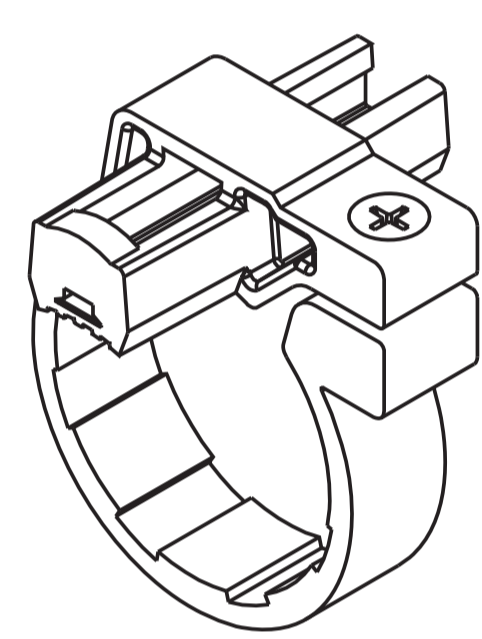

DH-M10DF **DH-M20DF**
DH-M12DF **DH-M25DF**
DH-M16DF

Fixing bracket for
M series cylinders

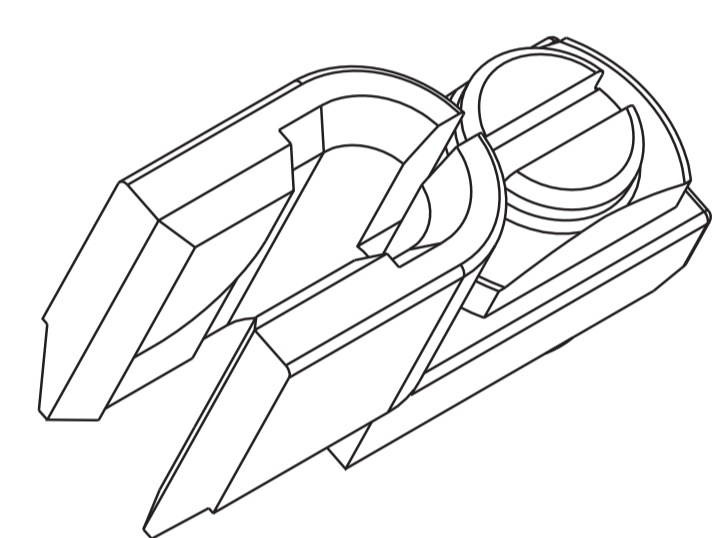

DF-001
Cable clamping

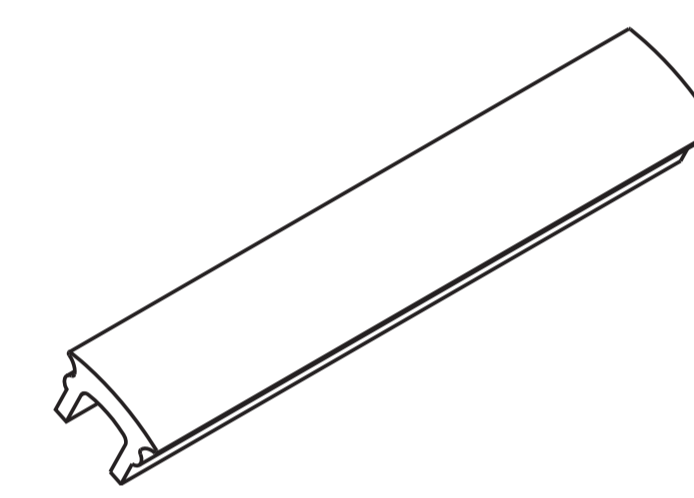

DHF-0020100
Covering strip

Electrical Circuit

A AC/DC 2 wires NO

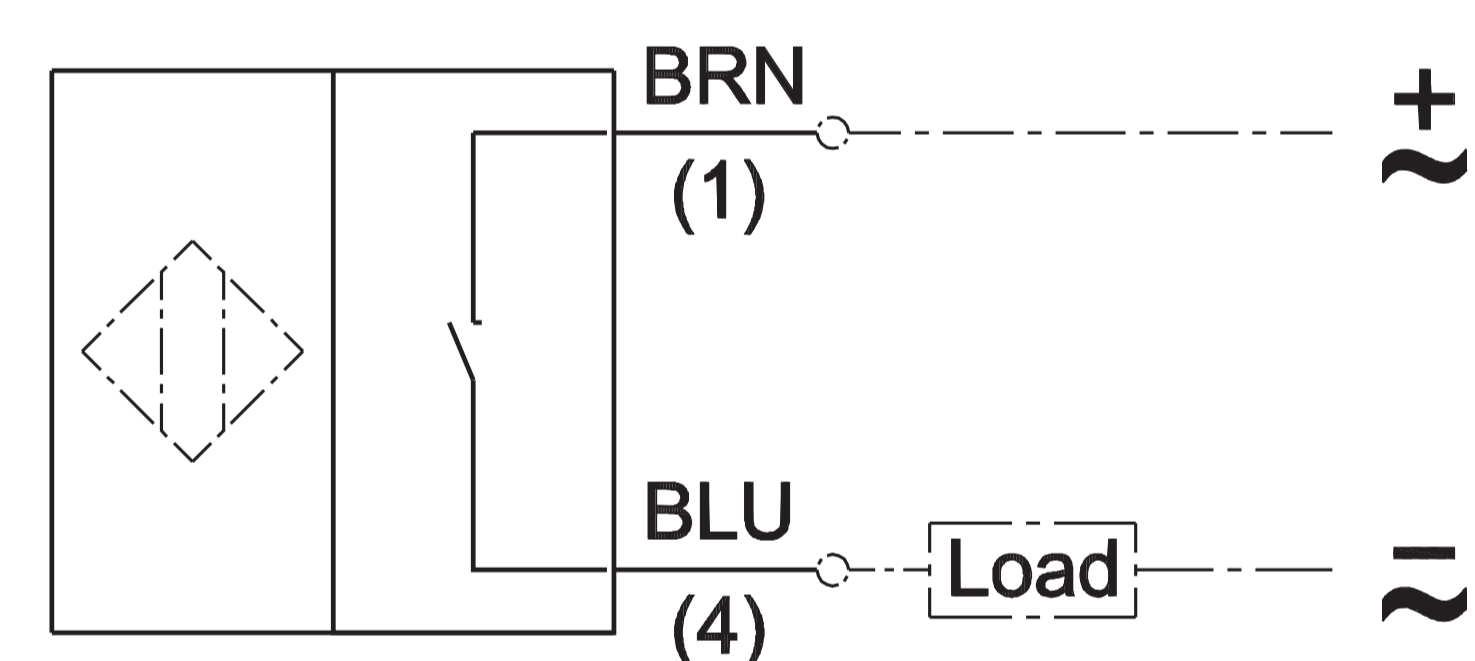

BRN = Brown BLK = Black BLU = Blue

C DC 3 wires PNP NO

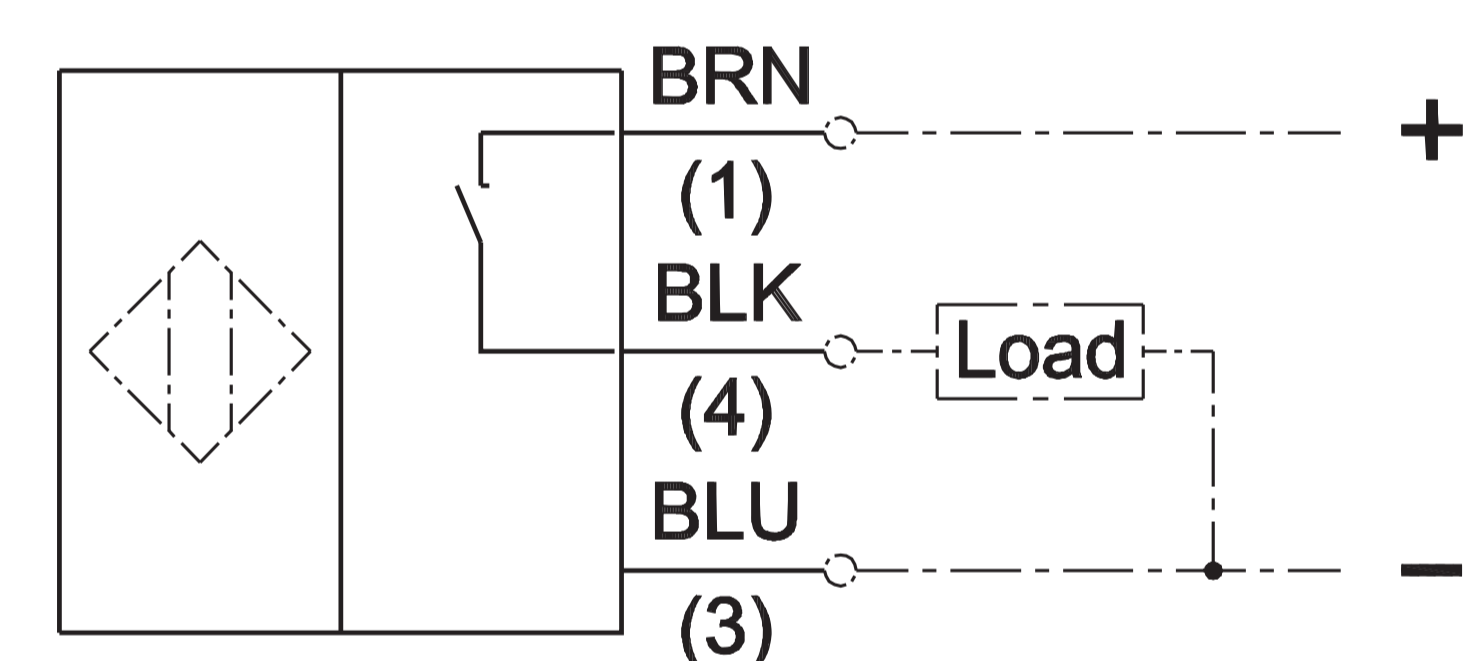

D DC 3 wires PNP NC

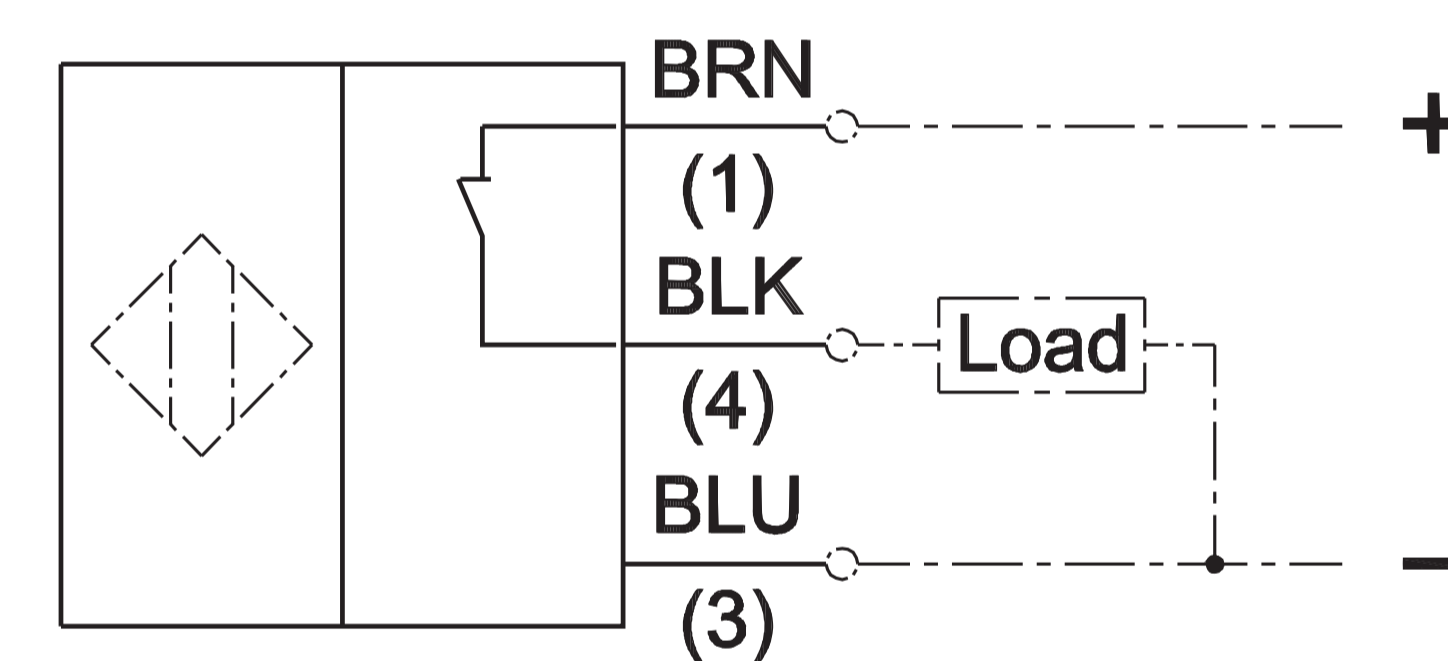

M08

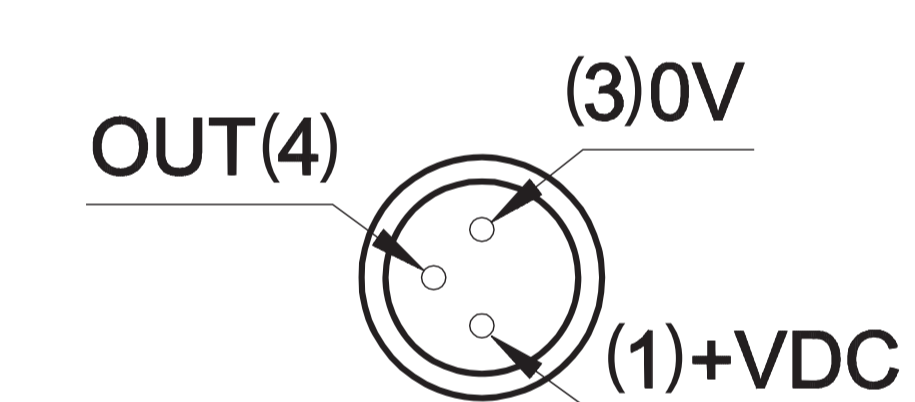

M12

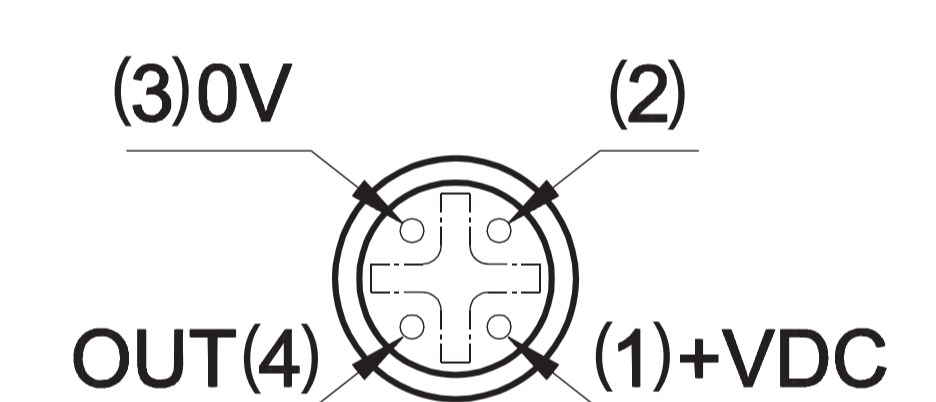

ASSEMBLY SCHEME

1

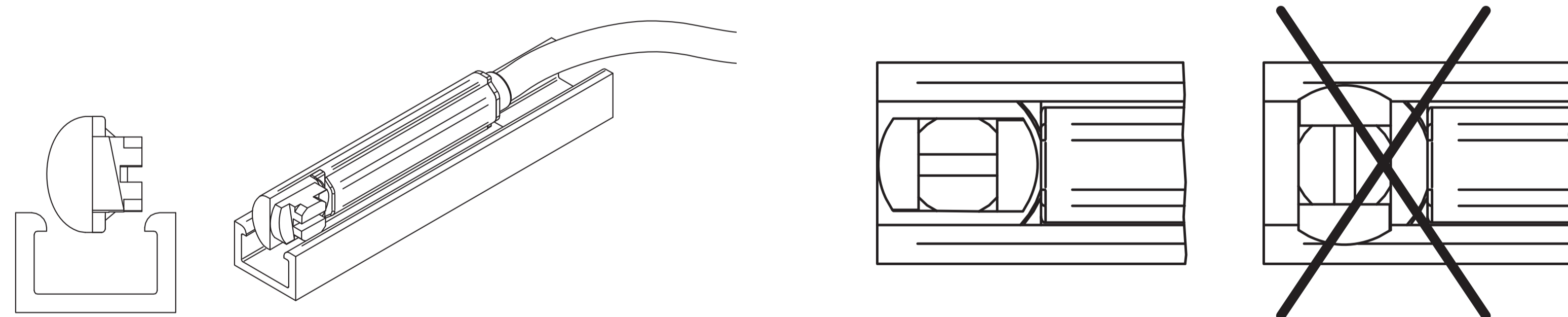

Put the sensor in the proper groove and make sure that the fastening plate has the slot for screwdriver along the sensor axis.

2

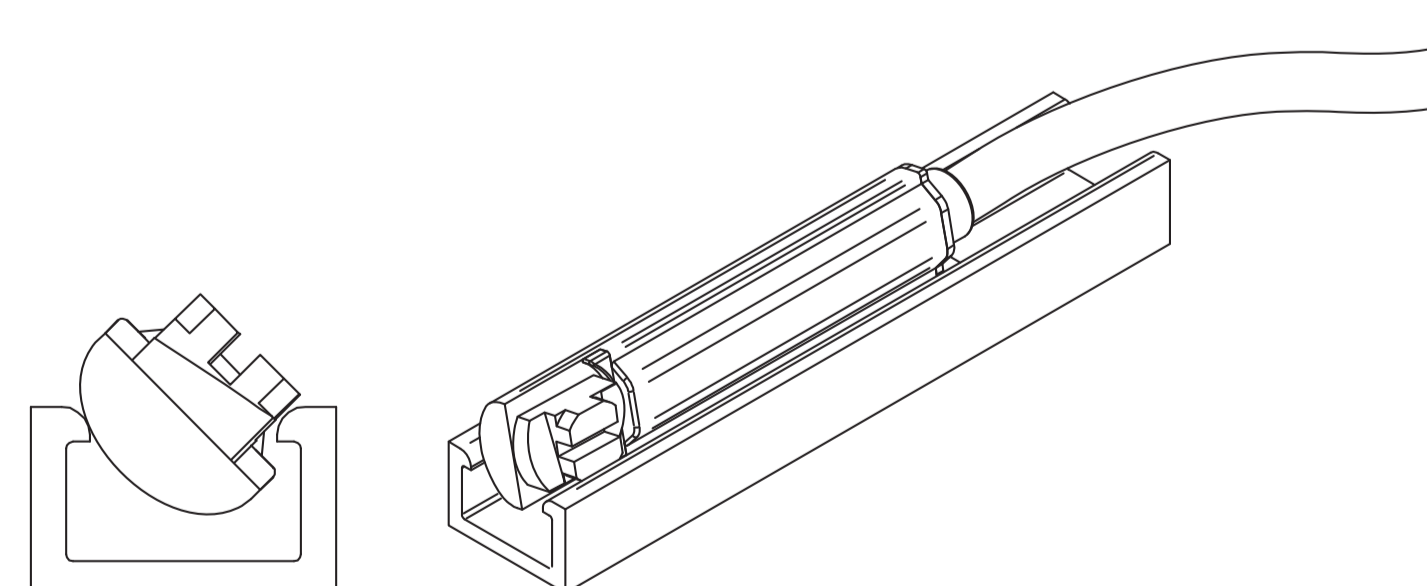

Put the sensor inside its groove and make sure that the fastening plate is on the open part of the groove.

3

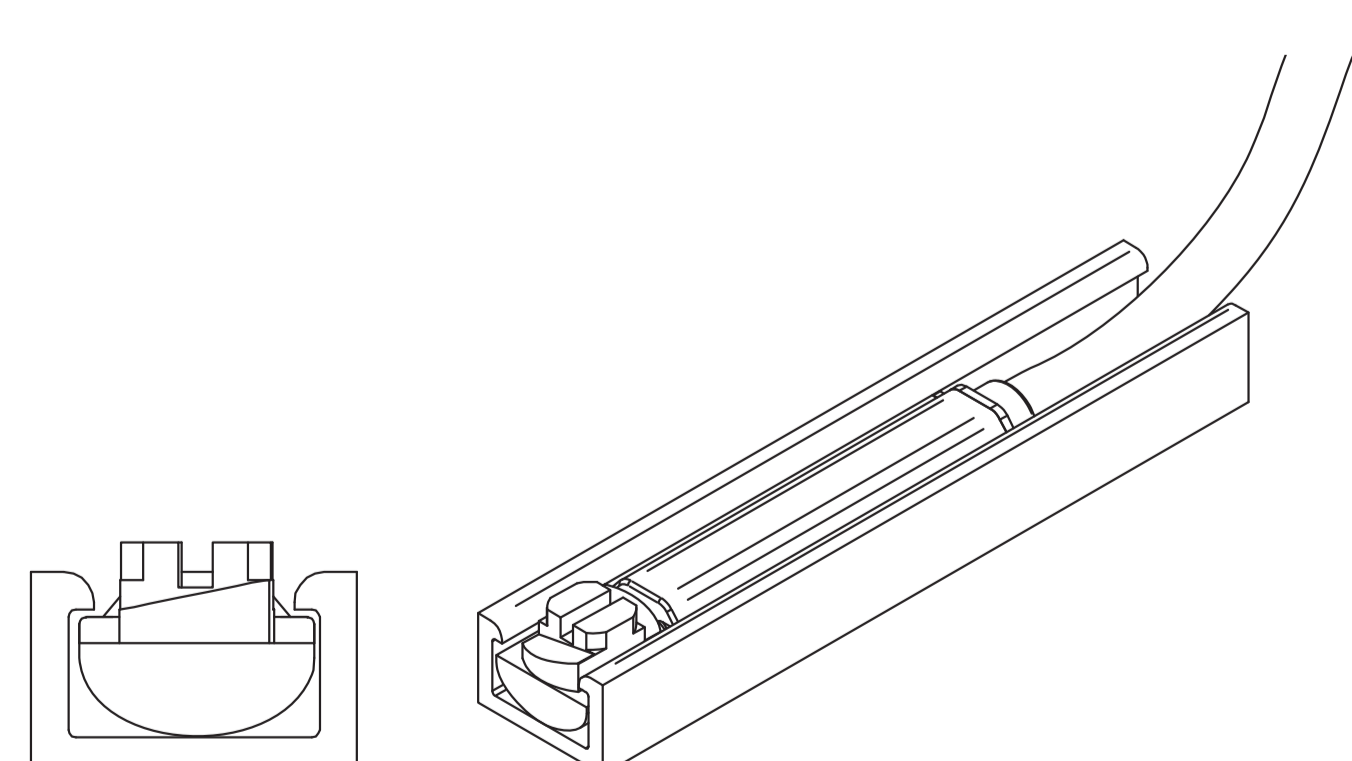

Check the correct position of the sensor in the groove.
Turn it to the wished position for detection.

4

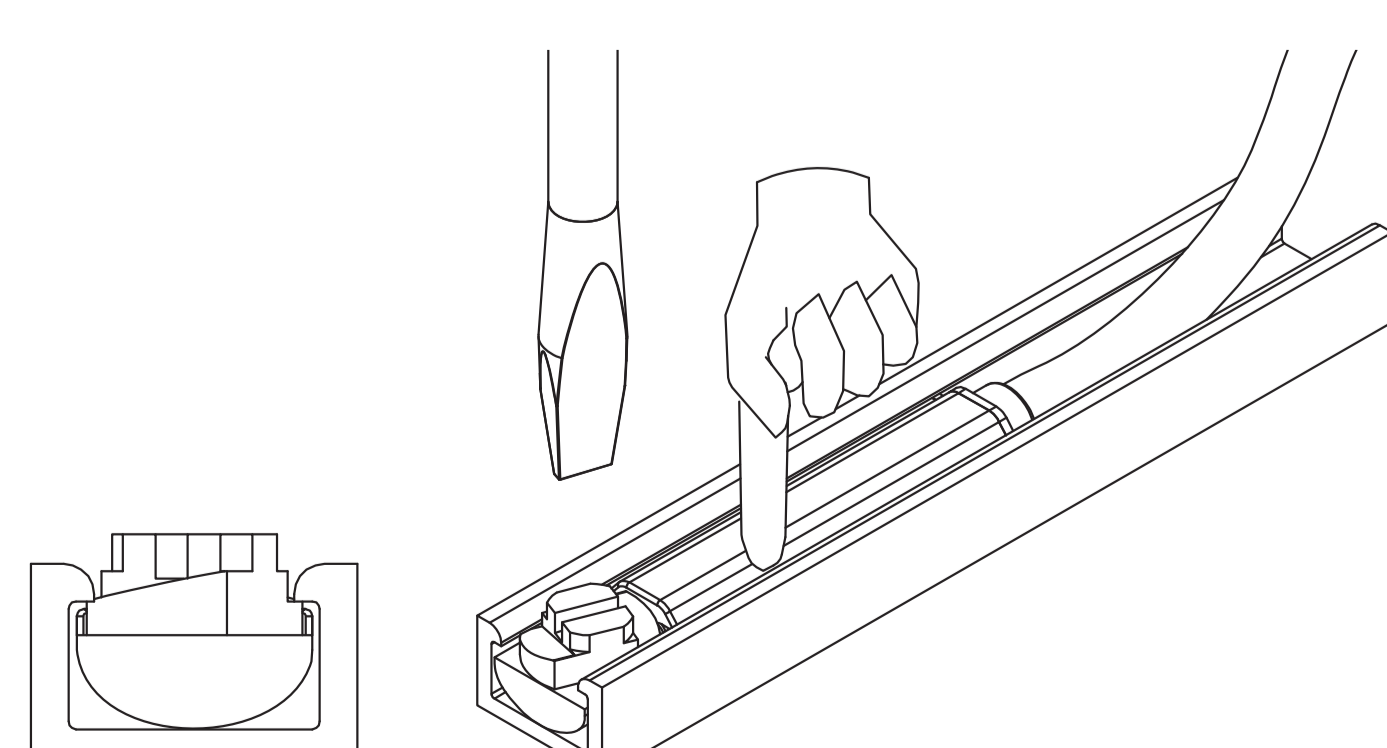

Keep the sensor in its position and screw the fastening plate to fix the sensor in the groove.
Max torque: 0,5 ÷ 1 Nm

DH



Other available versions
(M08-M12)

DH-200M08 DH-200M12
DH-500M08 DH-500M12
DH-700M08 DH-700M12

Cable extensions

DHF-033 M08 = 3 m M08
DHF-033 M12 = 3 m M12
DHF-053 M08 = 5 m M08
DHF-053 M12 = 5 m M12

■ Fixing elements

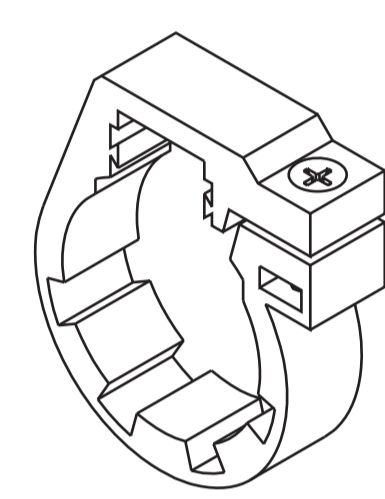

DH-M10 DH-M20
DH-M12 DH-M25
DH-M16

Fixing bracket for
M series cylinders

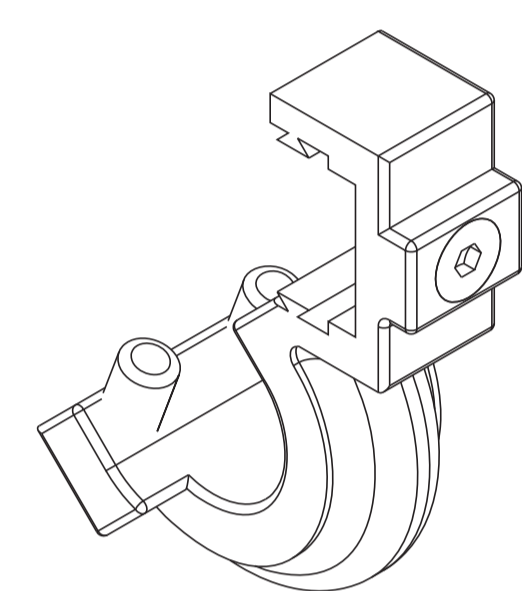

DH-K032050
DH-K063125
DH-K160200

Fixing bracket for
KE-K-KL series cylinders

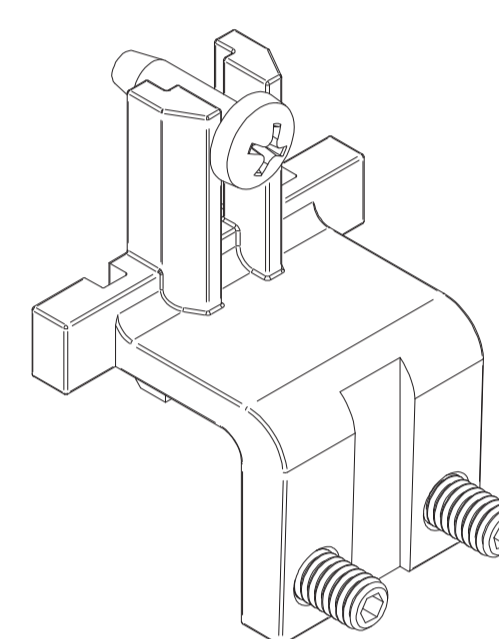

KM-032050-1
KM-063100-1
KM-125000-1

Fixing bracket for KM
sensors on ISO cylinders
(upon request)

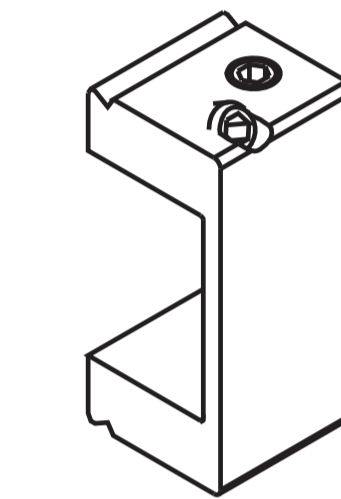

DH-S25
DH-S32
DH-S40
DH-S50

Fixing bracket for S1 series
rodless cylinders

Type	ELECTROMECHANICAL			ELECTRONIC
	Part No.	KM-032000	DH-200	DH-500
Working voltage (V AC/DC)	5÷250 V AC/DC	5÷250 V AC/DC	5÷250 V AC/DC	10÷30 V DC
Max switching voltage (mA)	1000	200	200	100
Max switching power (W/VA)	30	10	10	5
Max voltage drop (V AC/DC)	< 3,5	< 3,5	< 3,5	0,7
Minimum magnetic field (gauss)	85	85	60	30
Opening response time (ms)	< 0,5	< 0,5	< 0,5	0,08
Closing response time (ms)	< 1	< 1	< 1	0,03
Electric life with resistive load (cycles)	>10 ⁷	>10 ⁷	>10 ⁷	>10 ⁹
State indicator (LED)	red	red	red	red
Cable number and section (mmq)	2x0,25	2x0,25	2x0,25	3x0,25
Cable length (mm)	3000	3000	3000	3000
Electric circuit	A	A	A	C
Protection degree (EN60529)	IP65			
Working temperature (°C)	-20 ÷ +80			

DF-R/DF-T



Type	ELECTROMECHANICAL		ELECTRONIC	
	Part No.	DF-R200L02	DF-R200M08	DF-R700L02
Working voltage (V AC/DC)	5÷120 V AC/DC	5÷120 V AC/DC	5÷30 V DC	5÷30 V DC
Max switching voltage (mA)	100	100	50	50
Max switching power (W/VA)	10	10	1,5	1,5
Shock resistance (G)	30	30	50	50
Max voltage drop (V AC/DC)	2,5	2,5	1,5	1,5
Cable number and section (mmq)	2 x 2,8 (PUR)	2 x 2,8 (PUR)	3x3 (PUR)	3x3 (PUR)
Cable length (mm)	2000	150	2000	150
Contact	NO	NO	NO	NO
Max response time (ms)	1	1	1	1
State indicator (LED)	red	red	green	green
Electric circuit	A	-	C	-
Protection degree (NEMA 6)	IP67			
Working temperature (°C)	-10 ÷ +70			

Type	ELECTROMECHANICAL		ELECTRONIC	
	Part No.	DF-T200L03	DF-T200M08	DF-T700L03
Working voltage (V AC/DC)	5÷120 V AC/DC	5÷120 V AC/DC	5÷30 V DC	5÷30 V DC
Max switching voltage (mA)	100	100	200	200
Max switching power (W/VA)	10	10	6	6
Shock resistance (G)	30	30	50	50
Max voltage drop (V AC/DC)	2,5	2,5 V	1	1
Cable number and section (mmq)	2 x 2,8 (PUR)	2 x 2,8 (PUR)	3 x 2,8 (PUR)	3 x 2,8 (PUR)
Cable length (mm)	3000	150	3000	150
Contact	NO	NO	NO	NO
Max response time (ms)	1	1	1	1
Protection degree (NEMA 6)	red	red	green	green
Electric circuit	A	-	C	-
State indicator (LED)	IP67			
Working temperature (°C)	-10 ÷ +70			

■ Electrical Circuit

A AC/DC 2 wires NO

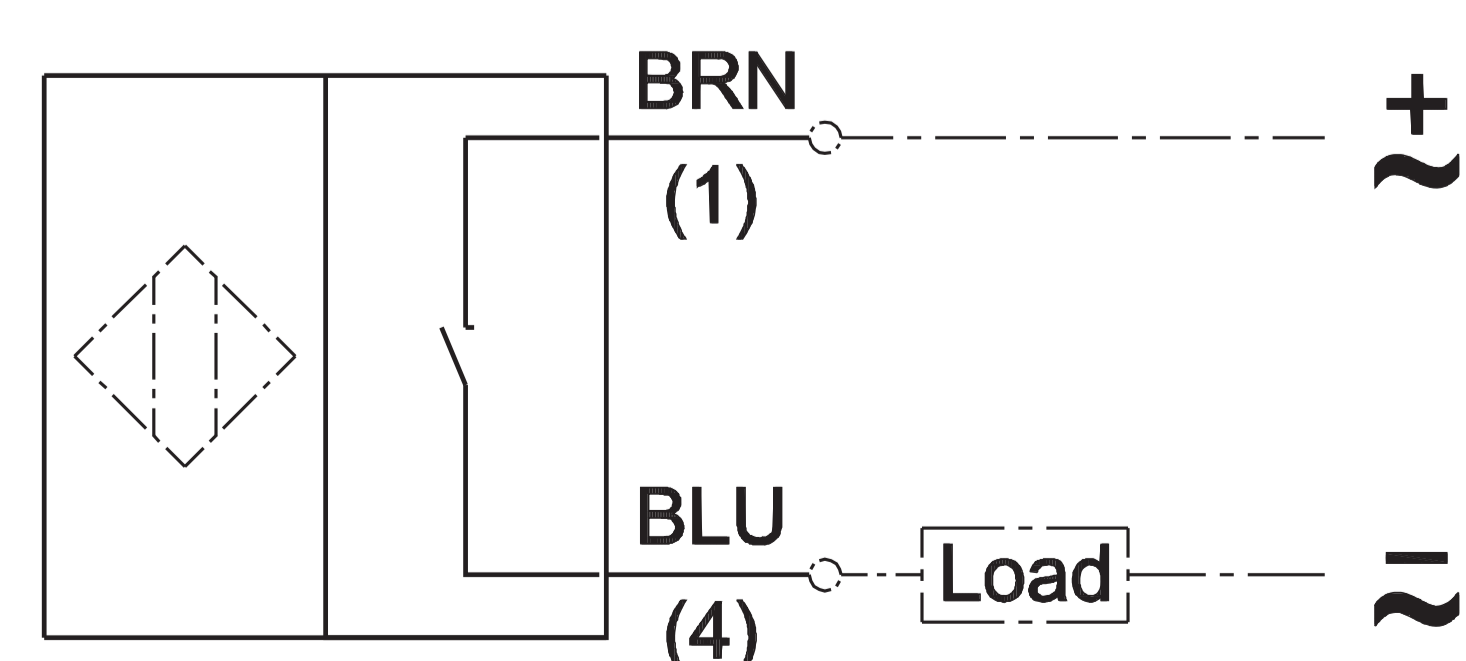

BRN = Brown BLK = Black BLU = Blue

C DC 3 wires PNP NO

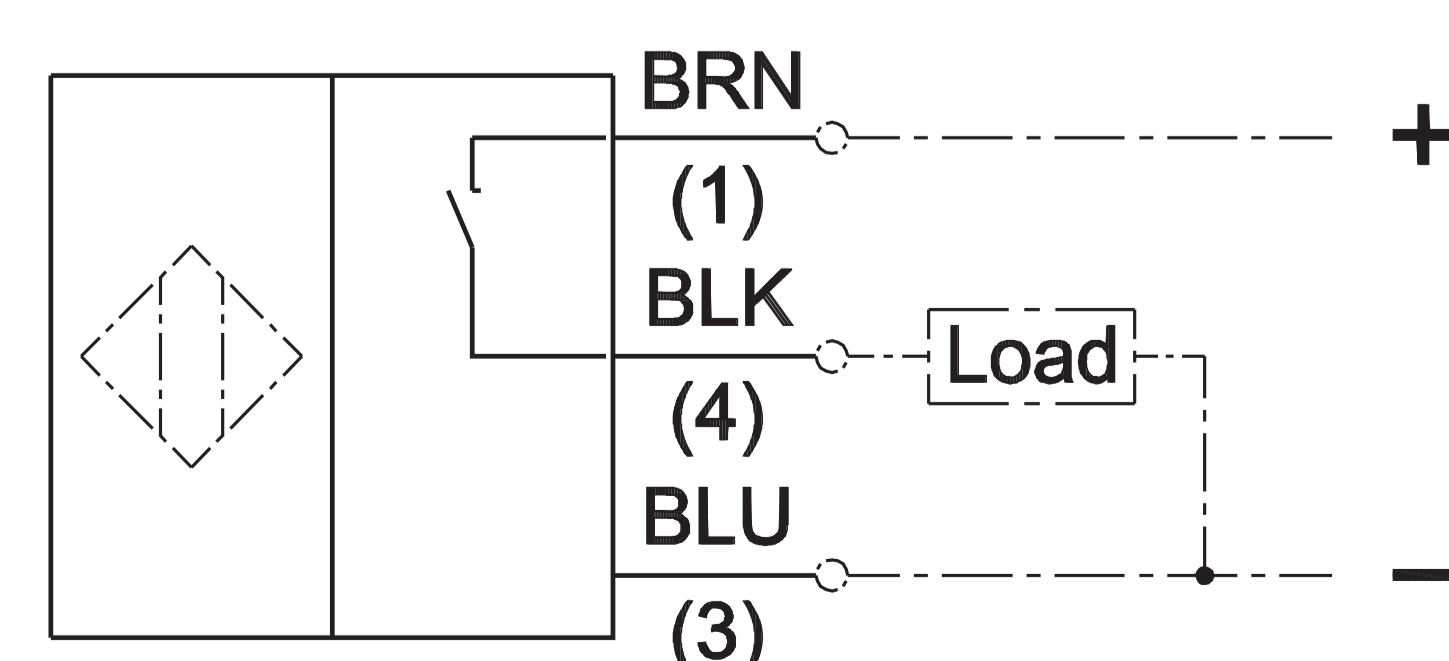

M8

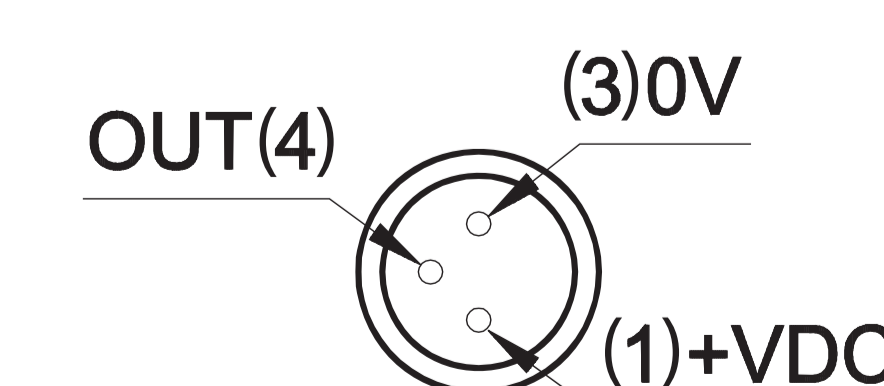

M12

