

CHARACTERISTICS

Ambient temperature	-20 ÷ 80 °C
Fluid	filtered air, with or without lubrication
Working pressure	3 ÷ 10 bar
End-caps	die-cast light alloy
Barrel	anodized aluminium
Piston	aluminium
Guide slide	acetalic resin
Piston seals	NBR
Shock absorber seals	mechanical
Cushionings	pneumatic adjustable (standard supplied)

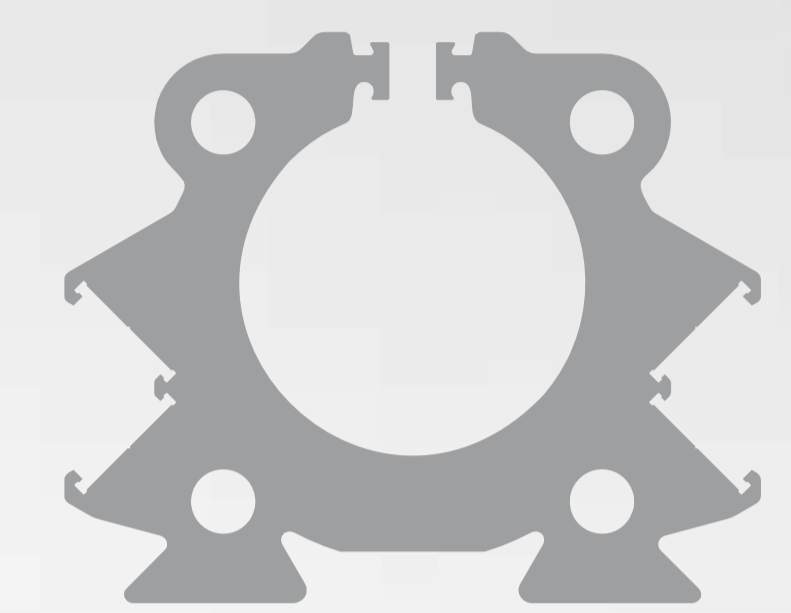

CODIFICATION KEY

V	L	1	2	2	1	1	3	2	0	8	5	0
		1	2	3	4	5	6	7				

1 Series VL1 = Ø 25÷50 mm - Rodless Cylinders with 90° integrated guides Sliding on ball bearings	2 Carriage type 2 = Medium carriage 3 = Long carriage	3 No. of ball bearing pairs standard supplied Medium carriage 2 = Ø 25÷40 3 = Ø 50 Long carriage 3 = Ø 25÷40 4 = Ø 50
---	--	--

4 Left end-cap supply port 0 = No supply port (both chambers are supplied from the right end-cap) 1 = Side supply port 2 = Bottom supply port 3 = Rear supply port	5 Right end-cap supply port 1 = Side supply port 2 = Bottom supply port 3 = Rear supply port 4 = Rear supply ports for both chambers on the right end-cap	6 Bore (mm) 25 = Ø25 32 = Ø32 40 = Ø40 50 = Ø50	7 Stroke (mm) Up to 6000
---	--	--	---

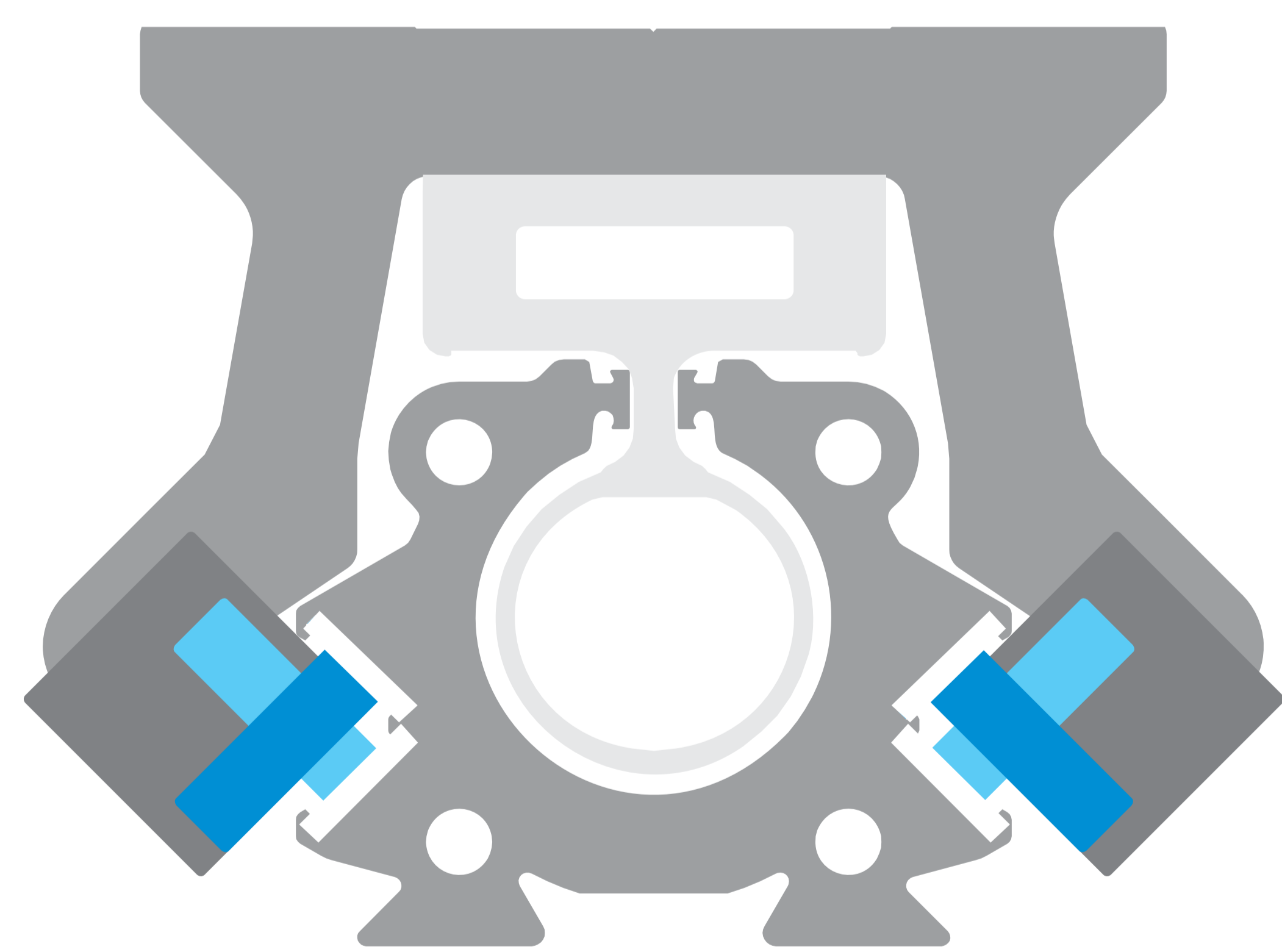

VL1

- Extruded aluminium profile Ø 25 ÷ 50 mm
- Stroke up to 6 m
- Heavy duty precision series
- Rigid guide system
- Sliding of the carriage on ball bearings
- Translation speed 0,2 ÷ 2 m/sec.
- Version with locking unit available

FIXING ELEMENTS

Ø	Angle bracket	Fixing plate
25	SF-13025	SF-12025
32	SF-13032	SF-12032
40	SF-13040	SF-12040
50	SF-13050	SF-12050

■ VL1 with L6 locking unit

