

### CHARACTERISTICS

Ambient temperature	-20 ÷ 80 °C
Fluid	filtered air, with or without lubrication
Working pressure	3 ÷ 10 bar

End-caps	die-cast light alloy
Barrel	anodized aluminium
Piston	aluminium
Guide slide	acetalic resin
Piston seal	NBR
Shock absorber seals	mechanical
Cushionings	pneumatic adjustable (standard supplied)

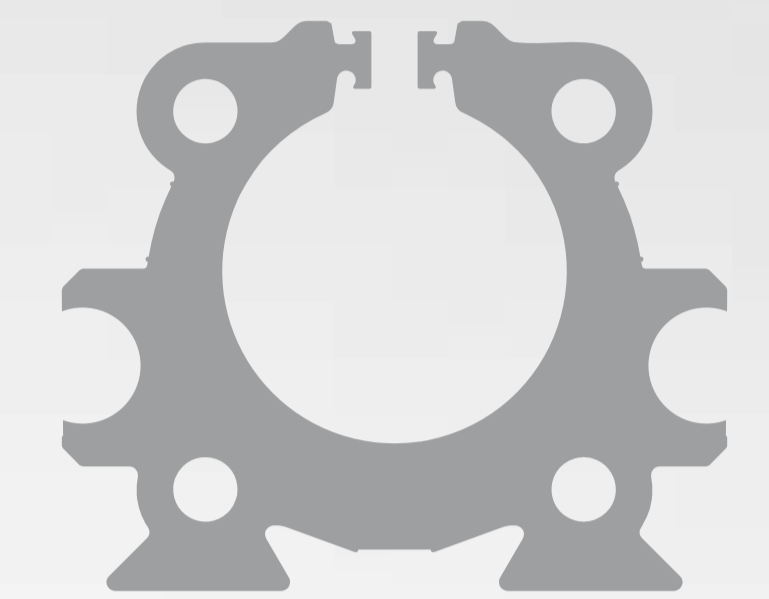

### CODIFICATION KEY

S	5	0	1	1	2	5	0	8	5	0
1	2	3	4	5	6					

<b>1 Series</b> S5 = Ø 25÷50 mm - Rodless Cylinders with integrated guides Technopolymer sliding guide	<b>2 Carriage type</b> 0 = Standard carriage (except Ø 40-50) 2 = Medium carriage 3 = Long carriage	<b>3 Left end-cap supply port</b> 0 = No supply port (both chambers are supplied from the right end-cap) 1 = Side supply port 2 = Bottom supply port 3 = Rear supply port
---	--	---

<b>4 Right end-cap supply port</b> 1 = Side supply port 2 = Bottom supply port 3 = Rear supply port 4 = Rear supply ports for both chambers on the right end-cap	<b>5 Bore (mm)</b> 25 = Ø25 32 = Ø32 40 = Ø40 50 = Ø50	<b>6 Stroke (mm)</b> Up to 6000
--	--	------------------------------------

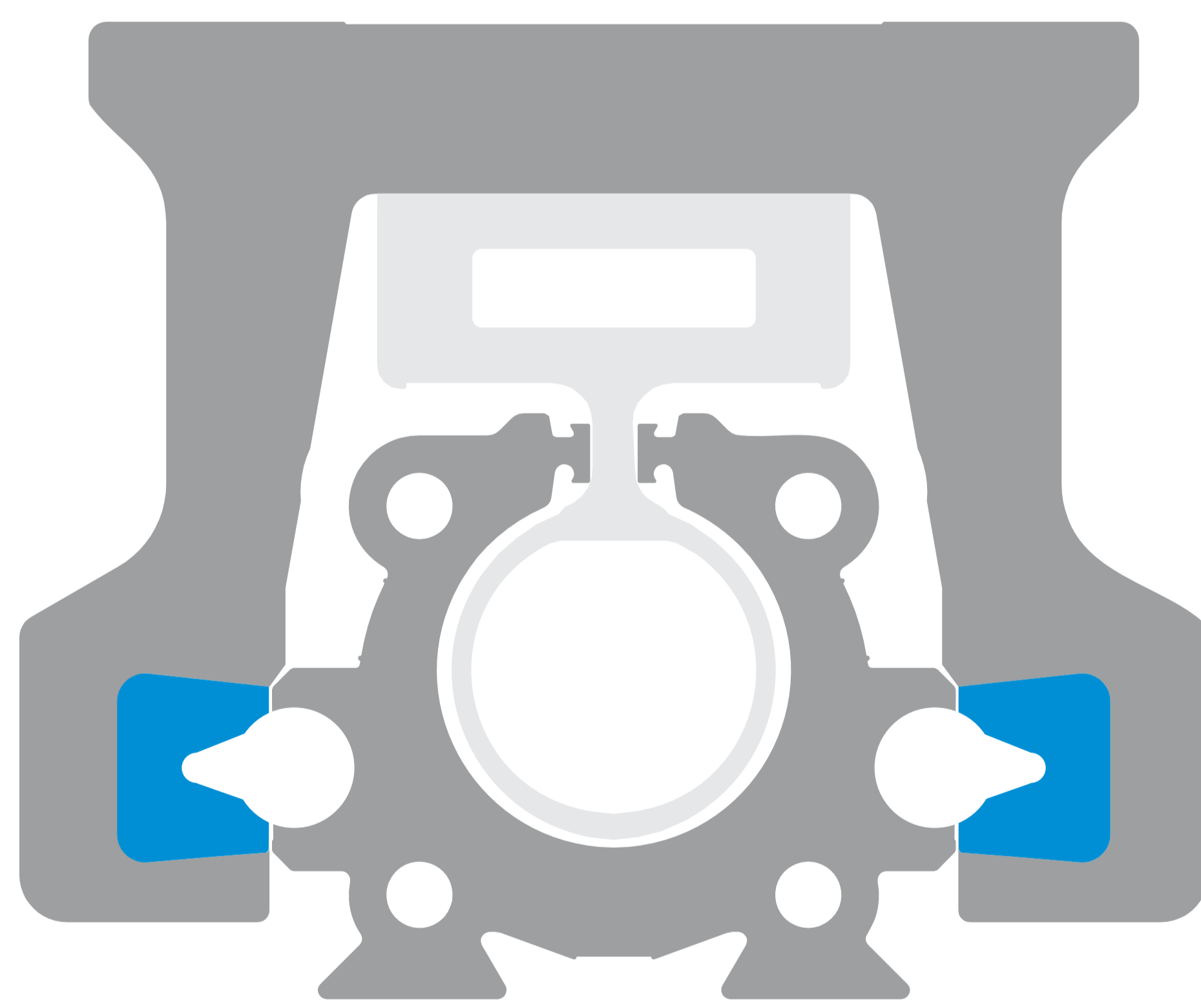

### S5

- Extruded aluminium profile Ø 25 ÷ 50 mm
- Stroke up to 6 m
- Flexible guide system
- Sliding of the carriage with plastic slide on steel shafts
- Translation speed 0,2 ÷ 1,5 m/sec.
- Version with locking unit available

### FIXING ELEMENTS

Ø	Angle bracket	Fixing plate
25	SF-13025	SF-12025
32	SF-13032	SF-12032
40	SF-13040	SF-12040
50	SF-13050	SF-12050

■ S5 with L6 locking unit

