

ORIGINAL

Locking system UNIVER Original since 1998

STATIC/DYNAMIC

Static locking and dynamic braking in a single device

POWERFUL

The highest locking force among market equivalent devices

SAFE

No rod slipping even if affected by oil and grease

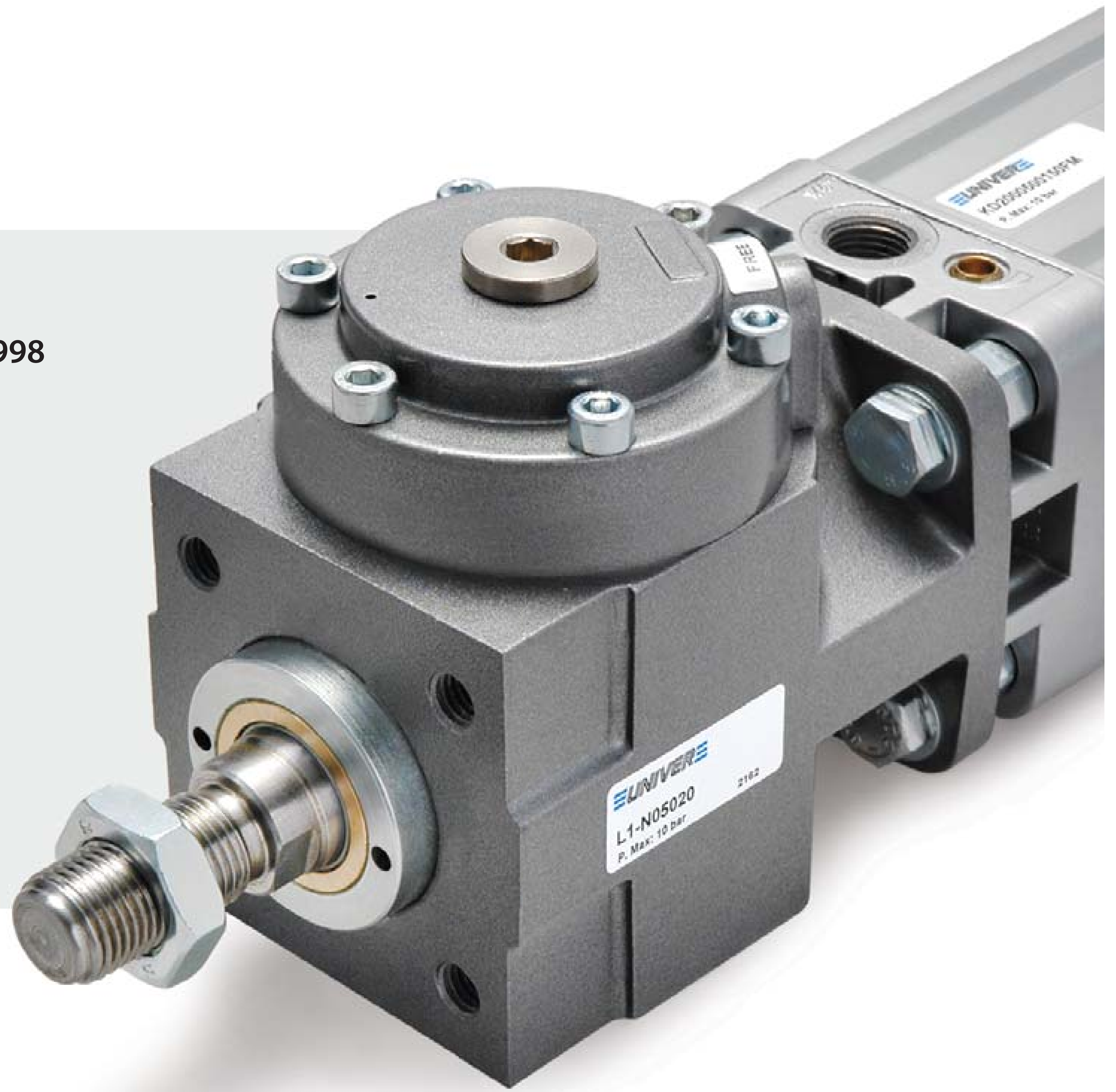

L1-N

For cylinders Ø 16 ÷ 125 mm

For piston rods Ø 6 ÷ 32 mm

M



KL
KE/K
KD



RS



Working principle

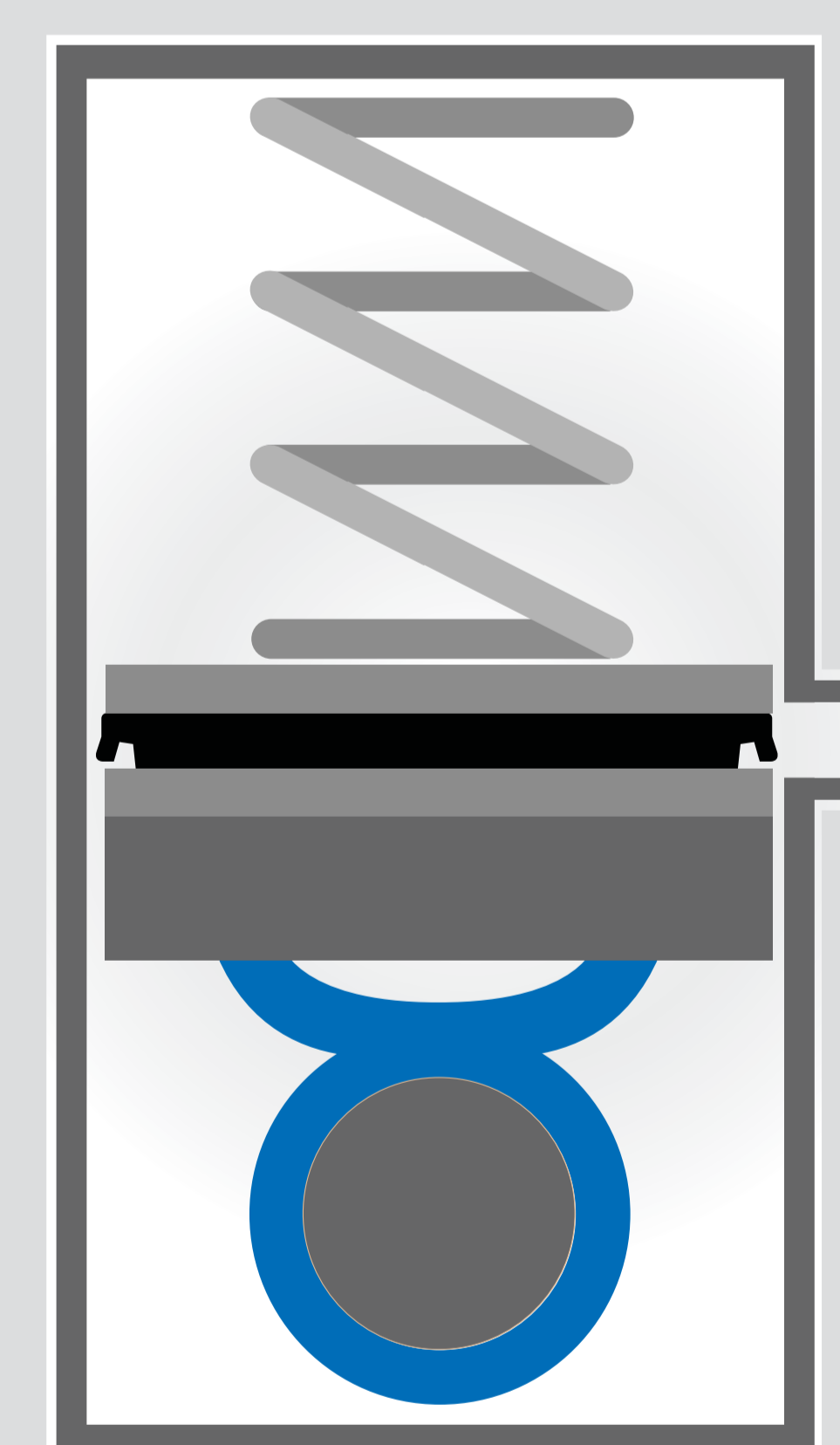

Locked piston rod

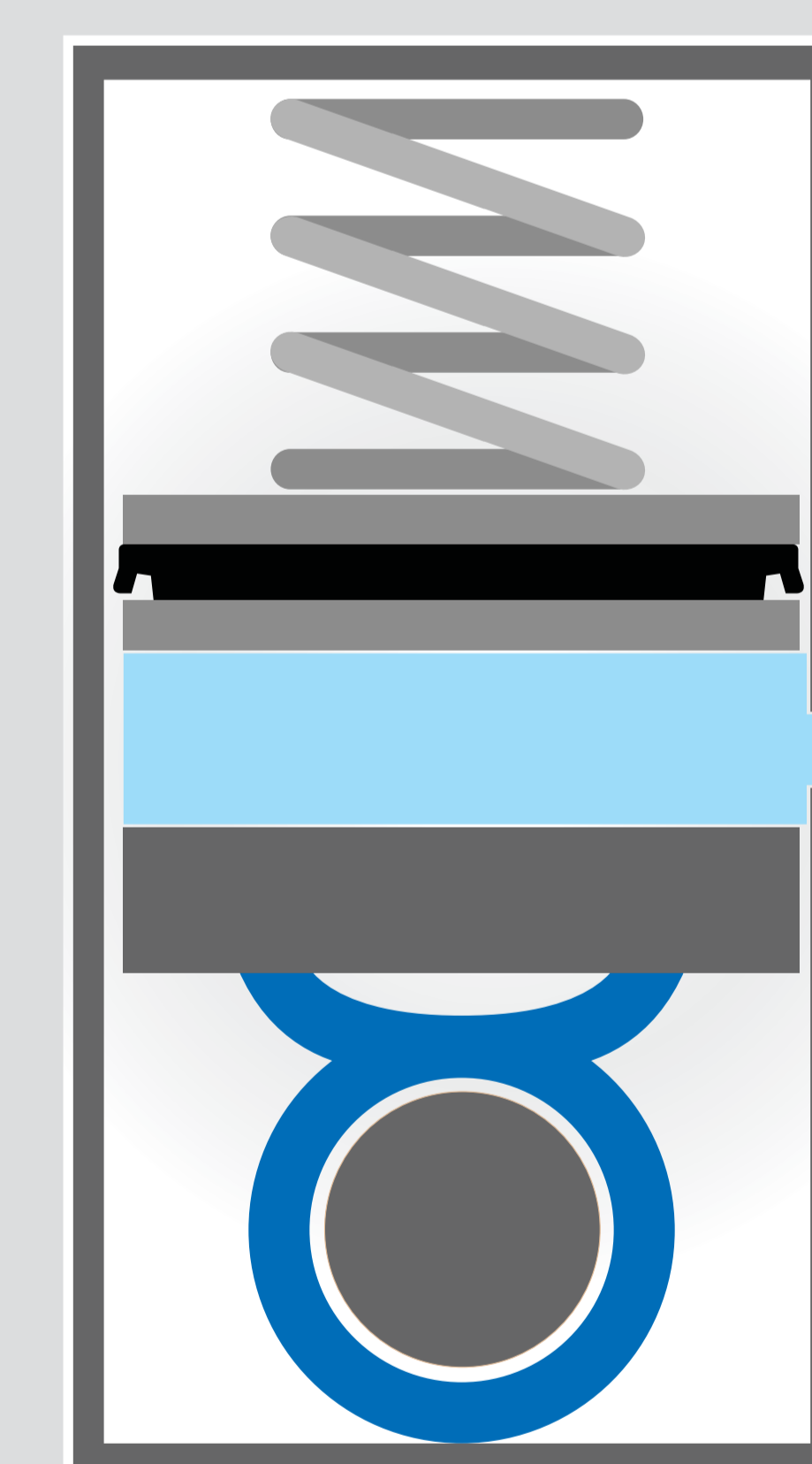

Free piston rod

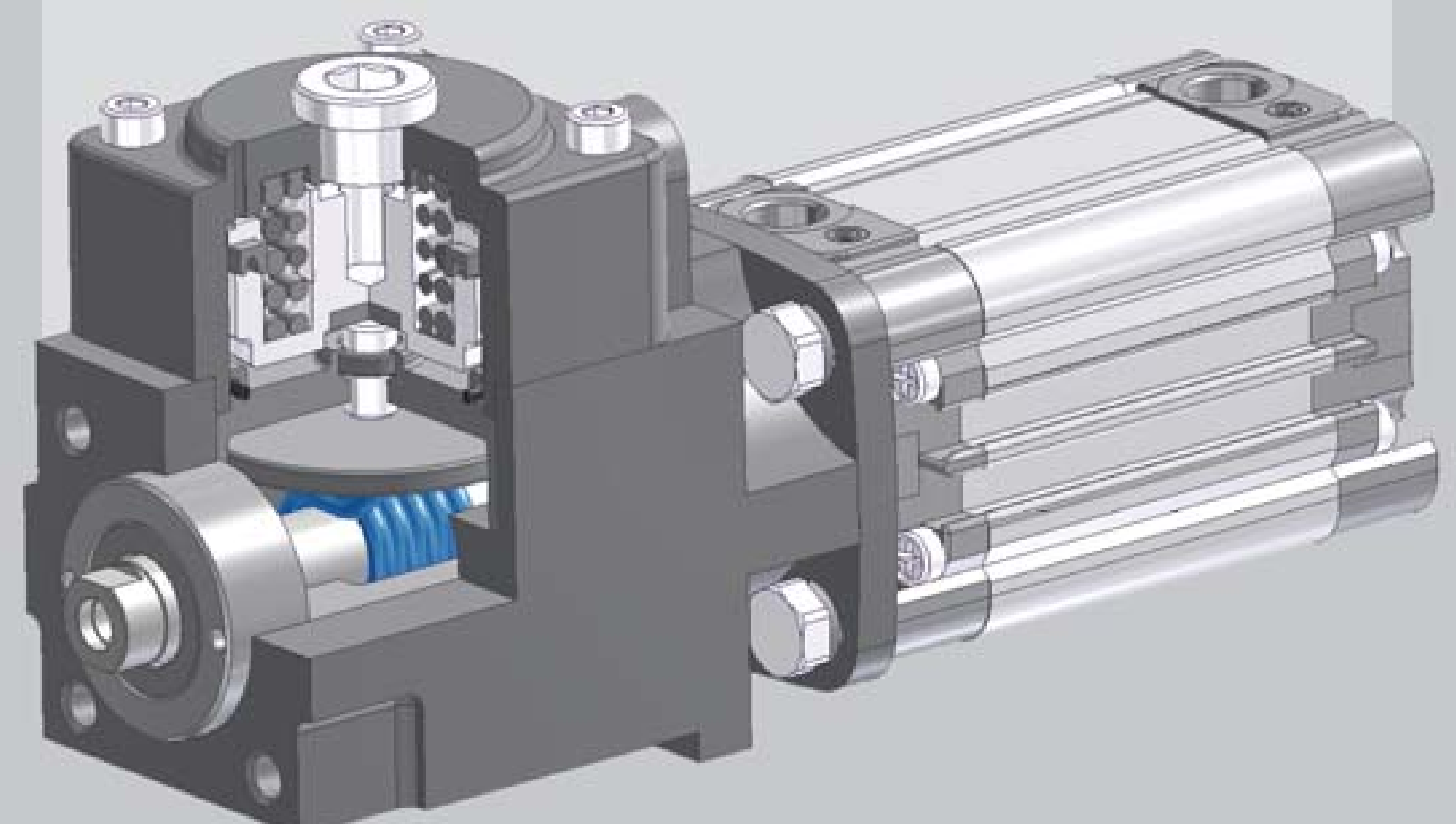

CHARACTERISTICS

| | |
|---------------------|---|
| Ambient temperature | -20 ÷ 30 °C |
| Fluid | filtered air, with or without lubrication |
| Working pressure | 4 ÷ 10 bar |
| Body | die-cast aluminium |
| Cover | die-cast aluminium |
| Piston | aluminium |
| Seals | nitrile rubber |
| Springs | special steel |

M, KL, KE/K, KD, RS series cylinders



CODIFICATION KEY

| | | | | | | | | | |
|---|---|---|---|---|---|---|---|---|--|
| L | 1 | - | N | 0 | 6 | 3 | 2 | 0 | |
| | 1 | | | 2 | | 3 | | 4 | |

| 1 Series | 2 Cylinder bore (mm) | 3 Piston rod bore (mm) | 4 Option |
|--|---|---|--|
| L1-N = Locking unit for cylinders and piston rod | 016 = Ø16 020 = Ø20 025 = Ø25 032 = Ø32 040 = Ø40 | 050 = Ø50 063 = Ø63 080 = Ø80 100 = Ø100 125 = Ø125 | 06 = Ø6 08 = Ø8 10 = Ø10 12 = Ø12 16 = Ø16 20 = Ø20 25 = Ø25 32 = Ø32 K = Metallic piston rod scraper upon request |

Core features and performance

| Ø | Ø rod (mm) | Static locking force | Pressure on the equivalent cylinder | Dynamic braking force | Response time at 6 bar | Stopping point repeatability | Vibration resistance | Shock resistance | Minimum release pressure |
|-----|------------|----------------------|-------------------------------------|---------------------------------|------------------------|------------------------------|---|------------------|--------------------------|
| | | N | bar | at 1m/s | ms | | | J | bar |
| 16 | 6 | 200 | 10 | 40% of the static locking force | 12 | < 1 mm at 1 m/s | 10 g (10-55 Hz) for 30 minutes on each axis | 2 | 4 |
| 20 | 8 | 314 | | | 12 | | | 3 | |
| 25 | 10 | 490 | | | 15 | | | 4 | |
| 32 | 12 | 800 | | | 20 | | | 5 | |
| 40 | 16 | 1260 | | | 20 | | | 8 | |
| 50 | 20 | 2000 | | | 25 | | | 11 | |
| 63 | 20 | 3100 | | | 25 | | | 15 | |
| 80 | 25 | 5000 | | | 30 | | | 21 | |
| 100 | 25 | 7850 | | | 30 | | | 29 | |
| 125 | 32 | 12300 | | | 40 | | | 40 | |

- **NFZ 160/200**
ISO 15552 cylinders with integrated locking unit



- Locking unit with optical positional device

