



Flow control switch - normally open or normally closed contact

- Adjustable switching point
- Low pressure loss
- Reliable under difficult conditions
- For liquid

The flow control switch is suitable for liquids as normally open or normally closed contact. The switching process is triggered by a reed contact. The flow moves the magnet, which is located on a rocker bar.









The switching point is adjustable. The flow control switch works reliably even under difficult conditions with low pressure drop. The switching process is well repeatable.

Technical data	
Repeatability	± 15 % (Switching point setting)
Maximum load	max. 1 A
Switching capacity	26 VA at max. 230 V AC 20 W at max. 48 V DC
Electrical connection	Cable plug DIN 43650 Form A
Nominal pressure	25 bar ¹⁾
Operating temperature	max. + 110 °C
Body material	Brass
Rocker bar	PPO (PPE/PA GFN3)
Protection class	IP65

¹⁾ Pressure data [bar]: Overpressure with respect to atmospheric pressure

Other versions on request

Ordering chart

DN [mm]	Article no.
G ¼	784322 
G ¾	784323 
G ½	784324 
G ¾	784325 
G 1	784326 
G 1 ¼	784327 
G 1 ½	784328 
G 2	784329 

Dimensions [mm]

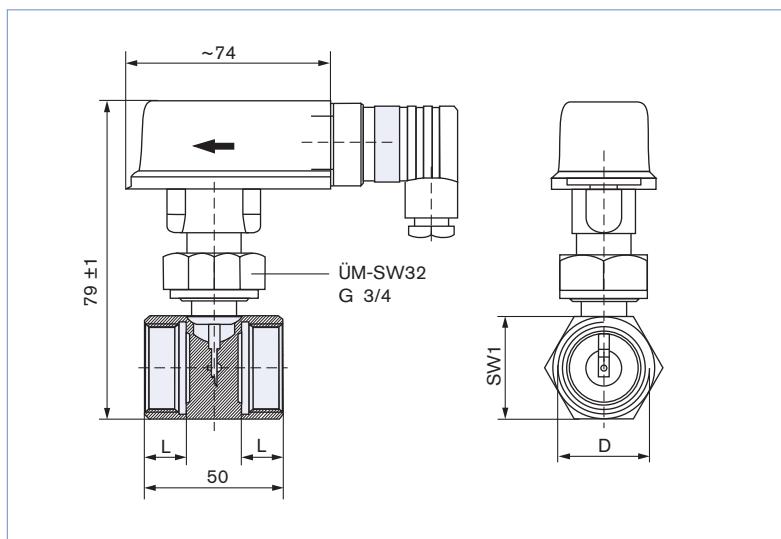

DN [mm]	D [mm]	SW1 [mm]	L [mm]	Switching point range ¹⁾		Max. flow rate [l/min]
				for ascending current [l/min]	for decreasing current [l/min]	
8	G ¼	27	11	2.1 ... 2.7	1.8 ... 2.4	45
10	G ¾	19	11	2.5 ... 3.2	2.2 ... 2.9	60
15	G ½	19	11	3.4 ... 4.2	3.0 ... 3.8	67
20	G ¾	27	15	7.0 ... 9.1	6.4 ... 8.2	120
25	G 1	32	15	13.5 ... 17.0	12.0 ... 15.5	195
32	G 1 ¼	41	15	15.5 ... 20.5	14.5 ... 19.0	240
40	G 1 ½	55	15	26.5 ... 34.5	25.5 ... 32.5	400
50	G 2	70	15	39.5 ... 51.0	39.0 ... 50.0	400

To find your nearest Bürkert facility, click on the orange box

www.burkert.comIn case of special application conditions,
please consult for advice.Subject to technical changes
© Christian Bürkert GmbH & Co. KG

1808/0_EU-en_1000364464